

MANIFOLD BLOCK ASSEMBLY - RETRACT

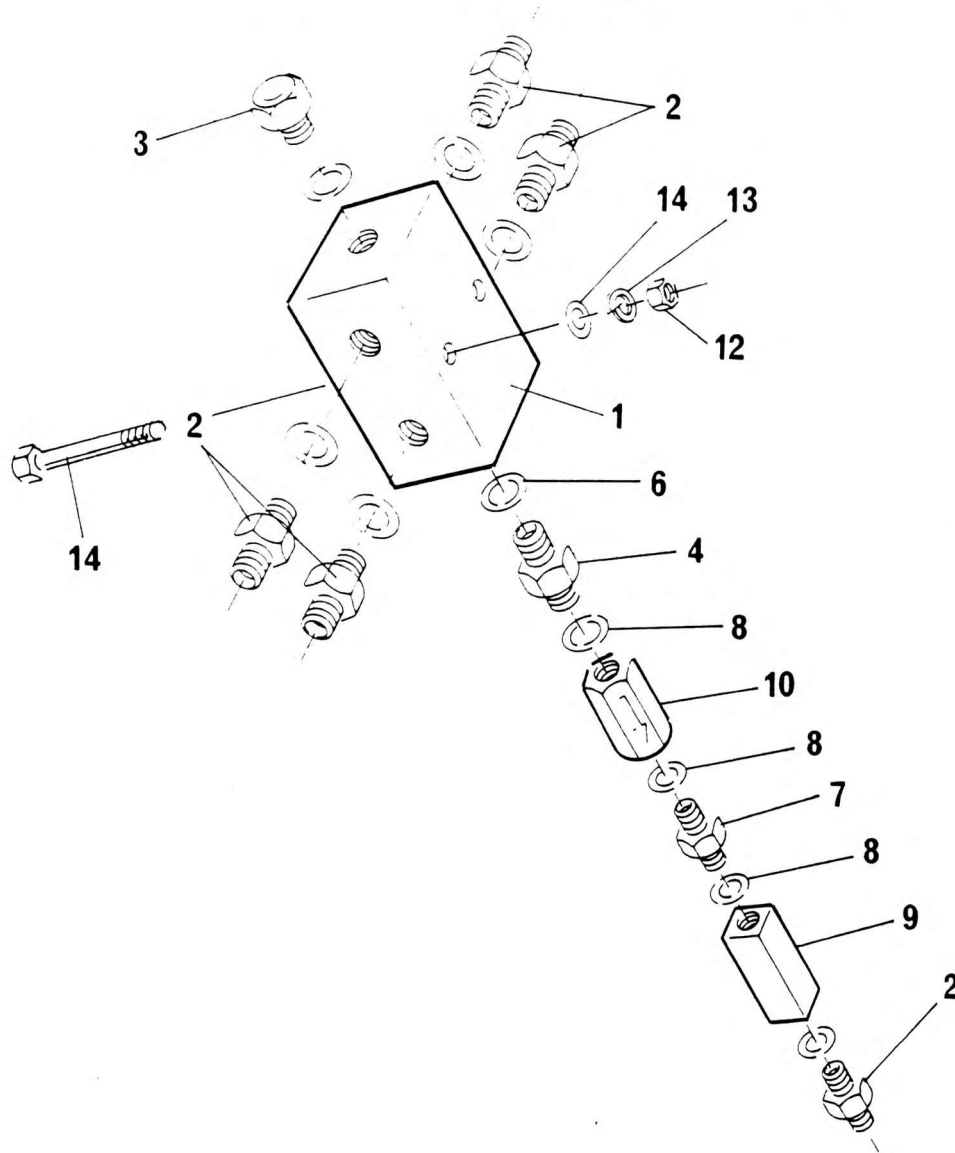

NO.	PART NO.	QTY.	DESCRIPTION	NO.	PART NO.	QTY.	DESCRIPTION
1	4-086-990037	1	Block Manifold				
2	7-443-990912	5	Adaptor $\frac{3}{8}$ " BSP				
3	14061	1	Plug				
4	513295	1	Adaptor $\frac{1}{2}$ " x $\frac{1}{4}$ " BSP				
5	7355204	6	Bonded Seal $\frac{3}{8}$ " BSP				
6	7355302	2	Bonded Seal $\frac{1}{2}$ " BSP				
7	35805	1	Adaptor $\frac{3}{8}$ " x $\frac{1}{4}$ " BSP				
8	7355201	2	Bonded Seal $\frac{1}{4}$ " BSP				
9+	8871178	1	Filter Restrictor				
10	8361392	1	Valve Non Return				
11	7069102	2	Nut M6				
12	7067214	2	Washer Spring M6				
13	7066536	2	Washer Plain M6				
14	7090108	2	Bolt M6 x 55 Long				

+ See further breakdown in this group

6-926-990463
Issue No. 02